



PART NUMBER

**PFR85-811**

DESCRIPTION

**REAR TIE BAR OUTER BUSH**

## INSTALLATION GUIDE

### Product description:

This part replaces OEM part number 5Q0501529C.

### Contents (parts per pack):

4 x Polyurethane Bushes, 2 x Sleeves, 2 x Outer Shells, 4 washers, 1 x Fitting Tools 1 x Grease

*Please read the complete fitting instructions and check package components before fitment. These fitting instructions are to be used as a guide and in conjunction with workshop manual.*

*It is recommended that:*

- all work to be carried out by a licensed technician;*
  - all safety precautions adhered to;*
  - wheel alignment to be checked and adjusted as required after any suspension work.*
- All fasteners must be tensioned to manufacturer's torque settings.*

### Fitting Instructions:

1. Remove the rear tie bar from the car.
2. Being careful not to distort the arm, position the supplied fitting tool into the outer slot of the tie bar & push the original outer bush out. Fig A.
3. Clean any dirt and corrosion from the bore of the tie bar.
4. Leaving the fitting tool in position on the tie bar, press the supplied outer shell into the tie bar. Remove tool. Insert PU bushes from both sides into the outer shell. Fig B.
5. Apply some of the supplied grease into the bore of the bushes and insert the stainless steel sleeve into the bore. Fig B.
6. Use the supplied washers to fit on the outside face of the PU bushes. Fig B.
7. Fit back the tie bar to the car. Tension all hardware to manufacturers recommended torque settings.

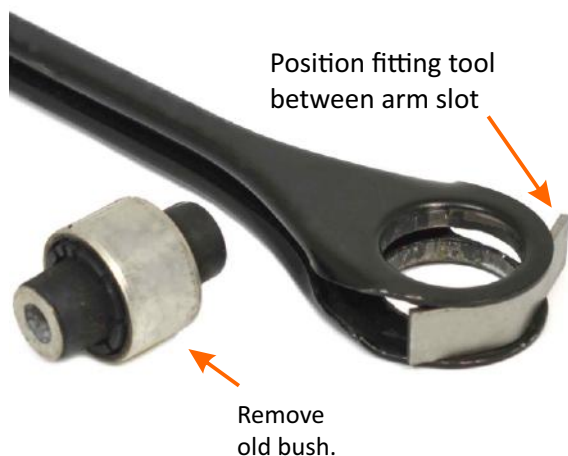

Fig A.

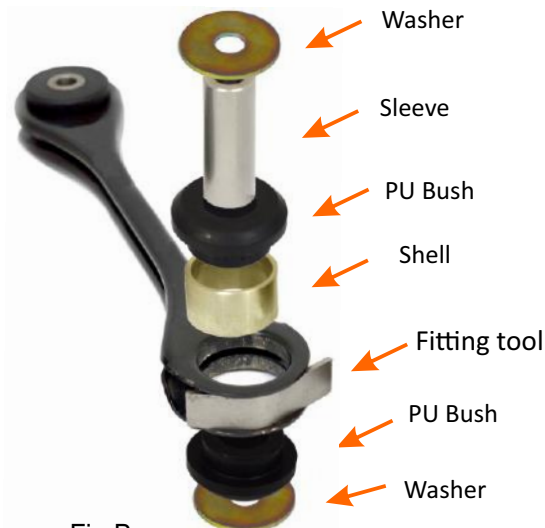

Fig B.