

POWERFLEX®

PART NUMBER
PFR5-632

DESCRIPTION
BMW E34 REAR DIFF REAR MOUNTING BUSH

INSTALLATION GUIDE

Contents (parts per pack):

2 x Polyurethane Bushes 1 x PTFE/Silicone Grease
2 x Stainless Steel Sleeves 2 x Stainless Steel Washers
2 x Zinc Plated Mild Steel Washers

Please read the complete fitting instructions and check package components before fitment. These fitting instructions are to be used as a guide and in conjunction with workshop manual.

It is recommended that:

- all work to be carried out by a licensed technician;
- all safety precautions adhered to;
- wheel alignment to be checked and adjusted as required after any suspension work.
- All fasteners must be tensioned to manufacturer's torque settings.



Fitting Instructions:

1. Remove the original bush and clean away any dirt and corrosion, remembering to also file away any sharp edges.

2. Insert the two Polyurethane Bushes into the bore in the arms. Ensure the brims of the Polyurethane Bushes are facing the inside of the car, as shown in Figure 1. Make sure the two Polyurethane Bushes sit flush inside the bores

3. Apply some of the supplied grease to the outer surface of the Stainless Steel Sleeve, and insert it into the bore of the Polyurethane Bush, until it sits flush within the Bore.

4. Insert the Stainless Steel Washer into the recessed section of the Polyurethane Bush, until it sits flush.

5. Assemble the Zinc Plated Mild Steel Washer to the outer face of the Polyurethane bush and refit the arm, ensuring to tension all hardware to the manufacturer's torque settings.

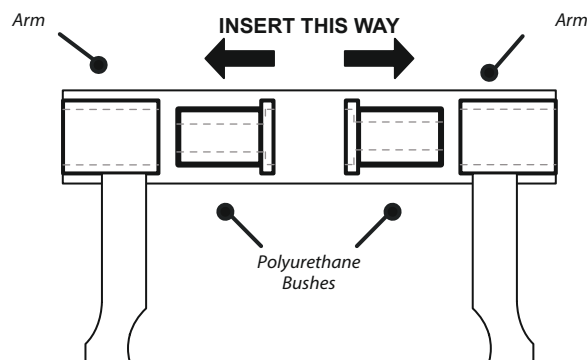

Figure 1 - Positioning of Polyurethane Bushes

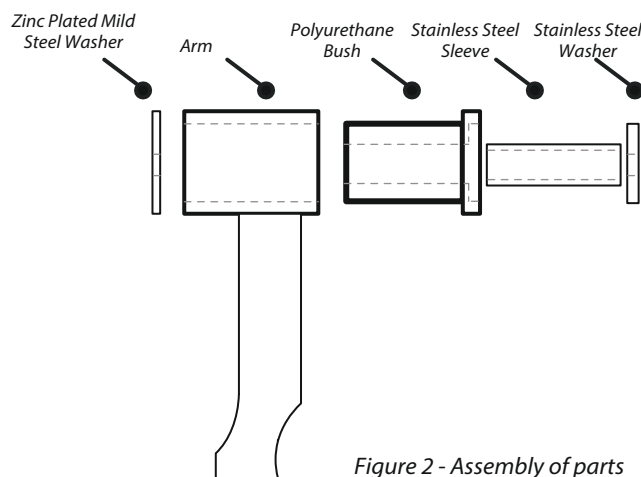

Figure 2 - Assembly of parts