



PART NUMBER

PFR3-508G

DESCRIPTION

REAR TRAILING ARM FRONT BUSH TOE ADJUST

INSTALLATION GUIDE

Product description:

This part replaces OE number: 1J0505171B and has been engineered to reduce 0.5° of excessive toe in.

Contents (parts per pack):

- 2 x A Part Polyurethane bushes
- 2 x B Part Polyurethane bushes
- 2 x Stainless steel sleeves
- 1 x PTFE / Silicone Bush Assembly Grease

Please read the complete fitting instructions and check package components before fitment. These fitting instructions are to be used as a guide and in conjunction with workshop manual. It is recommended that:

- all work to be carried out by a licensed technician;
 - all safety precautions adhered to;
 - wheel alignment to be checked and adjusted as required after any suspension work.
- All fasteners must be tensioned to manufacturer's torque settings.

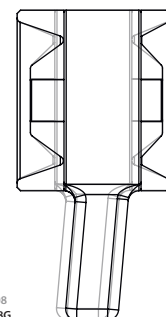

POWERFLEX PFR3-508
POWERFLEX PFR3-508G

Fitting Instructions:

1. Remove original bush from the rear trailing arm, clean any dirt and corrosion from the bore in the arm. Using file remove any sharp edges from the bore of the arm.
2. Push the A part polyurethane bush into the arm from the inside of the car.
3. Push the B part polyurethane bush into the arm from the outside of the car.
4. Apply the supplied PTFE / Silicone grease to the bore and end faces of each bush and insert the stainless steel sleeve into each bush.
5. Re-fit the arm to the car and tension all hardware to manufacturers recommended torque settings.

