

POWERFLEX®

PART NUMBER

PFR3-1120

DESCRIPTION

REAR SUBFRAME MOUNTING BUSHES

INSTALLATION GUIDE

Contents (parts per pack):

4 x PFR3-1120A Bushes	1 x PTFE/Silicone Grease
4 x PFR3-1120B Bushes	4 x Aluminium Sleeves
8 x Mild Steel Washers (4 with holes, 4 without)	8 x Spring Pins

Please read the complete fitting instructions and check package components before fitment. These fitting instructions are to be used as a guide and in conjunction with workshop manual.

It is recommended that:

- all work to be carried out by a licensed technician;
- all safety precautions adhered to;
- wheel alignment to be checked and adjusted as required after any suspension work.
- All fasteners must be tensioned to manufacturer's torque settings.

Fitting Instructions:

1. Remove the original rubber bush including its outer shell from the subframe.
 2. Clean away any dirt and corrosion from the vacant hole and file away any sharp edges using a rounded file.
 3. Insert the bushes into the bore of the subframe, with the PFR3-1120A (thinner top hat) on the top and PFR3-1120B (thicker top hat) on the bottom as shown in Fig 1.
 4. Insert the spring pins into the small holes on each aluminium sleeve (2 per sleeve).
 5. Apply some of the supplied grease to the bore of the bushes and push in the aluminium sleeves, until flush.
- Note: Ensure the orientation of each sleeve offset corresponds with Fig 2, which shows the correct position of each sleeve. The 2 front bushes should be offset pointing towards the front of the car, and the 2 rear bushes should be offset facing the rear of the car.**
6. Fit the washer with the small holes on top of the thinner PFR3-1120A bush, so that the holes locate onto the spring pins.
 7. Fit the washer without holes to the underside of the thicker PFR3-1120B bush.
 8. Refit the subframe to the vehicle and tension all hardware to the manufacturers recommended torque settings.



Figure 1

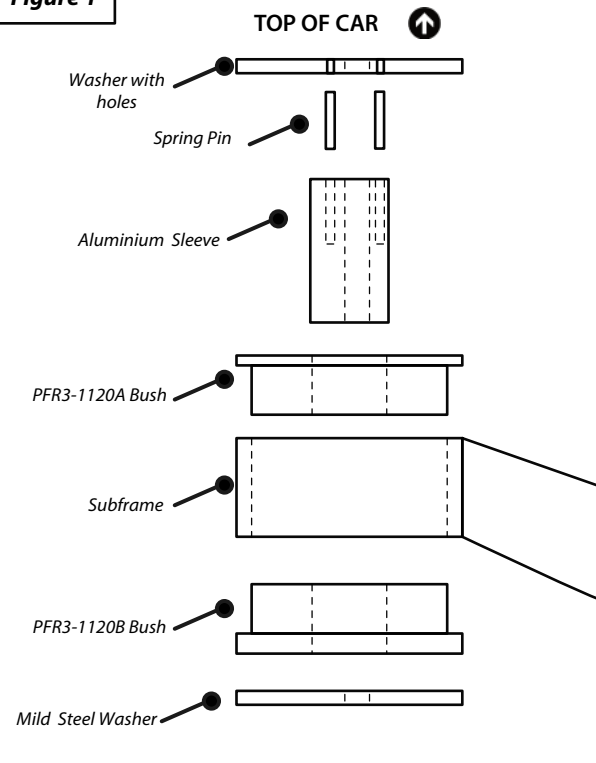

Figure 2

