



PART NUMBER

**PFF26-114G**

DESCRIPTION

**Rear Upper Control Arm Bush Adjustable**

INSTALLATION GUIDE

**Contents (parts per pack):**

8 x Polyurethane Bushes	4 x Outer Shells
4 x Stainless Steel Sleeves	1 x PTFE/Silicone Grease
2 x Stainless Steel Washers	1 x Fitting Tool
8 x Plated Mild Steel Washers	

*Please read the complete fitting instructions and check package components before fitment. These fitting instructions are to be used as a guide and in conjunction with workshop manual.*

*It is recommended that:*

- all work to be carried out by a licensed technician;*
- all safety precautions adhered to;*
- wheel alignment to be checked and adjusted as required after any suspension work.*
- All fasteners must be tensioned to manufacturer's torque settings.*

**Fitting Instructions:**

1. Remove the original rubber bush including its outer shell from the arm.

**Note: When removing the OE bush from the arm, place the supplied fitting tool between the arm to ensure the arm does not collapse whilst pressing as shown in Fig 1.**

2. Clean any dirt and corrosion from the bore of the arm, removing any burrs or sharp edges with a rounded file.

3. With the fitting tool still in place, press the outer shells into the arm as shown in Fig 2. Start with the lead-in and ensure it is square to the arm when being pressed in. Remove the fitting tool once finished.

4. Push each of the polyurethane bushes into the shells until flush.

5. Place one of the supplied washers onto each sleeve, pushing it up against the adjustable sleeve head.

6. Apply some of the supplied grease to the bore of the bush and press in the stainless steel sleeves. They should be orientated so that the adjustable head is on the hub side of the arm. The sleeves are intentionally longer than the bushes to allow for the washer fitment.

7. Fit the remaining supplied plated washers to each of the remaining open bush faces when presenting the arm to the vehicle.

8. Fit one of the large OE washers to the nut-side of the outer arm to hub bush as shown in Fig 2.

9. For maximum negative camber, use the supplied spanner to rotate the sleeve so that the bore is positioned as shown in Fig 2. Fine adjustment to your own requirements during a geometry set-up will be needed.

10. Tension all hardware to the manufacturer's recommended torque settings.



# POWERFLEX®

PART NUMBER

**PFF26-114G**

DESCRIPTION

Rear Upper Control Arm Bush Adjustable

## INSTALLATION GUIDE

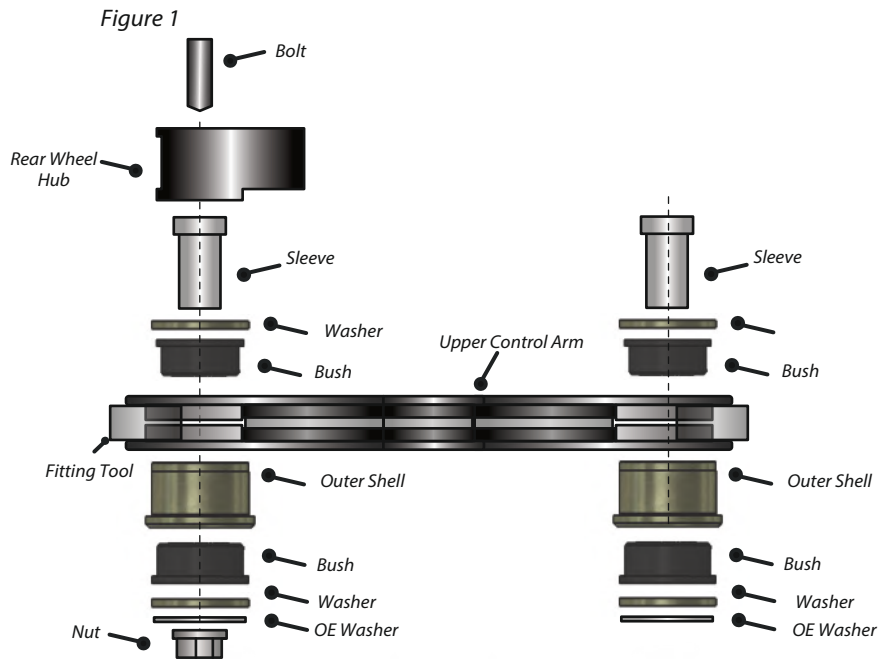

Figure 2



Sleeve adjusted to give maximum negative camber



Sleeve adjusted to give maximum positive camber

Figure 3