

# POWERFLEX®

PART NUMBER

## PFR25-1430

DESCRIPTION

### REAR TOP MOUNT BUSH

#### INSTALLATION GUIDE

#### Contents (parts per pack):

2 x Polyurethane Bushes

Please read the complete fitting instructions and check package components before fitment. These fitting instructions are to be used as a guide and in conjunction with workshop manual.

It is recommended that:

- all work to be carried out by a licensed technician;
- all safety precautions adhered to;
- wheel alignment to be checked and adjusted as required after any suspension work.
- All fasteners must be tensioned to manufacturer's torque settings.

#### Fitting Instructions:

1. Remove the interior access boot trim panels to gain access to the top of the shock absorber.
2. Remove the shock absorber top mounting nut, including the washer and original upper foam bush.
3. Fit the Powerflex bush with the taper facing downwards towards the chassis.
4. Re-fit the factory washer and nut and tension all hardware to the manufacturers recommended torque settings.



Figure 1 - fitted image

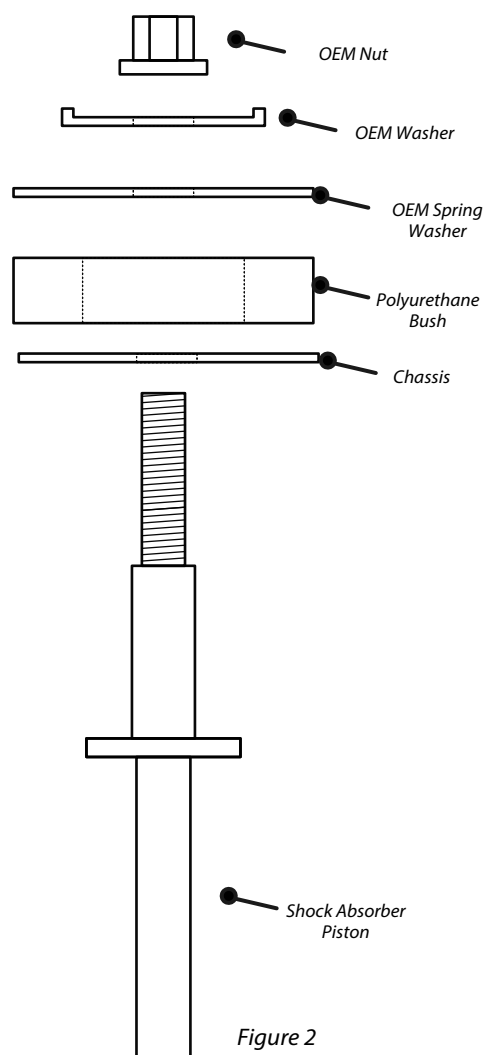

Figure 2