

POWERFLEX®

PART NUMBER

PFR19-1915

DESCRIPTION

REAR TOE LINK ARM BUSH

INSTALLATION GUIDE

Contents (parts per pack):

8 x Polyurethane Bushes 1 x Grease
4 x Outer Shells 4 x Stainless Steel Sleeves

Please read the complete fitting instructions and check package components before fitment. These fitting instructions are to be used as a guide and in conjunction with workshop manual.

It is recommended that:

- all work to be carried out by a licensed technician;
- all safety precautions adhered to;
- wheel alignment to be checked and adjusted as required after any suspension work.
- All fasteners must be tensioned to manufacturer's torque settings.



Fitting Instructions:

1. Remove the old bushes from the arms.
2. Remove any sharp edges and clean any dirt or corrosion from the arm bores.
3. Press the outer shell in the bore of the arm with the larger diameter towards the top of the arm and then insert the PU bushes into the outer shell.
4. Apply the supplied grease into the bore of PU bushes and insert the stainless steel sleeve into the bore of the bush.
5. Fit back arm to the car and tension all hardware to manufacturers recommended torque settings.

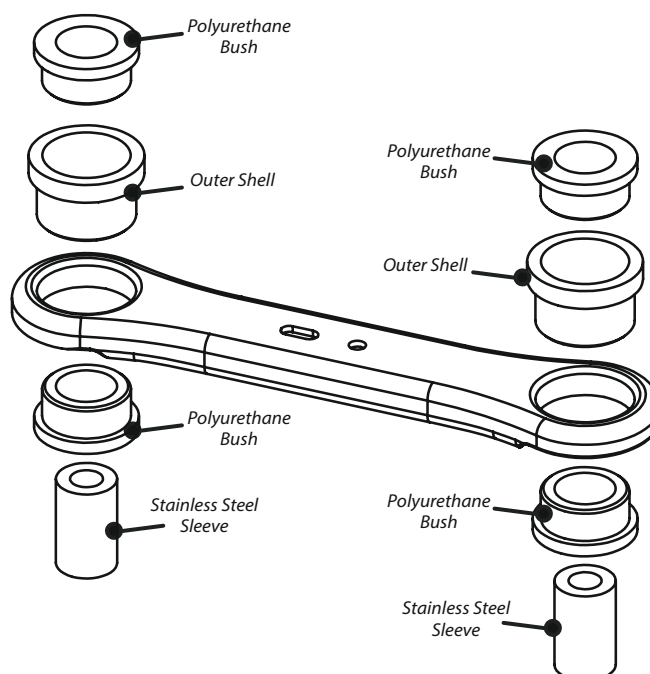

Figure 1 - diagram showing how the polyurethane parts will fit inside the toe link arm