

POWERFLEX®

PART NUMBER

PFR1-604

DESCRIPTION

Rear Trailing Arm to Hub Bush

INSTALLATION GUIDE

Contents (parts per pack):

- 4 x Polyurethane Insert Bush
- 2 x Stainless Steel Sleeve
- 1 x PTFE/Silicone Grease

Please read the complete fitting instructions and check package components before fitment. These fitting instructions are to be used as a guide and in conjunction with workshop manual.

It is recommended that:

- all work to be carried out by a licensed technician;
- all safety precautions adhered to;
- wheel alignment to be checked and adjusted as required after any suspension work.
- All fasteners must be tightened to manufacturer's torque settings.



Fitting Instructions:

1. Support the weight of the rear hub and remove the bolt from the trailing arm.
2. Remove the original bush including its outer shell from the hub assembly.
3. Clean away any dirt and corrosion, removing any sharp edges or burrs with a rounded file and fit the polyurethane bushes into either of the hub eyelet.
4. Apply some of the supplied grease to the bore of the bush and press in the stainless steel sleeve.
5. Bolt the trailing arm back into position and re-assemble with the original washer placed as shown in Fig. 1.
6. Tighten all hardware to the manufacturers recommended torque settings.

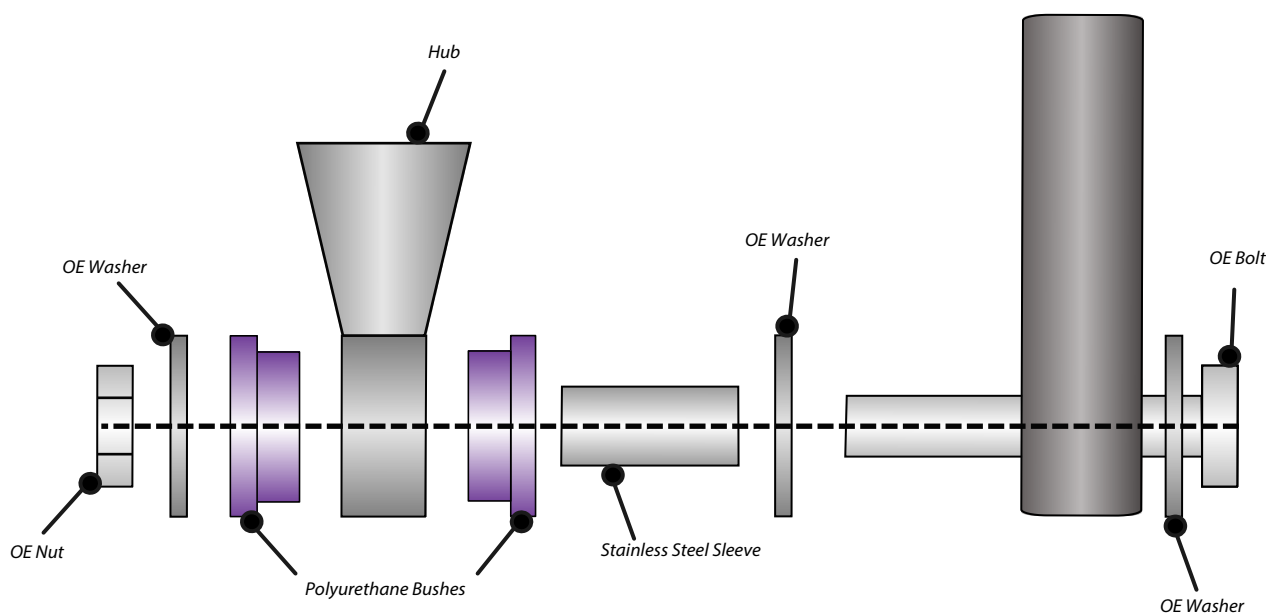

Figure 1