

POWERFLEX®

PART NUMBER

PFF88-1901

DESCRIPTION

Front Wishbone Front Bush

INSTALLATION GUIDE

Contents (parts per pack):

- 2 x Polyurethane Bushes 1 x PTFE/Silicone Grease
- 4 x Zinc Plated Mild Steel Shells 2 x Stainless Steel Sleeves
- 2 x Zinc Plated Mild Steel Washers

Please read the complete fitting instructions and check package components before fitment. These fitting instructions are to be used as a guide and in conjunction with workshop manual.

It is recommended that:

- all work to be carried out by a licensed technician;
- all safety precautions adhered to;
- wheel alignment to be checked and adjusted as required after any suspension work.
- All fasteners must be tensioned to manufacturer's torque settings.



Fitting Instructions:

1. Remove the front wishbone from the vehicle.
2. Using a workshop press and suitable adapters, push the OEM bush including its out sleeve out of the front position of the wishbone.
3. Use a wire brush to clean up the mating surfaces around the bore on the top and bottom of the arm, and sand/clean away any dirt, burrs or sharp edges from the bore.
4. Using the press again, push two of the metal shells into the arm, one from each direction, until the top lip meets the arm (Figure 1).
5. Press the Polyurethane bush into the bore of the fitted metal shells (Figure 1). The use of washing up liquid as a lubricant is recommended.
6. Apply the supplied grease to the outside of the stainless sleeve and the tapered bore of the bush, and push the sleeve into place in the bush (Figure 1).
7. Use a small amount of grease to stick the washer to the top of the sleeve (Figure 1).
8. Refit the wishbone to the car, and ensure to tighten all hardware to manufacturers recommended torque settings.

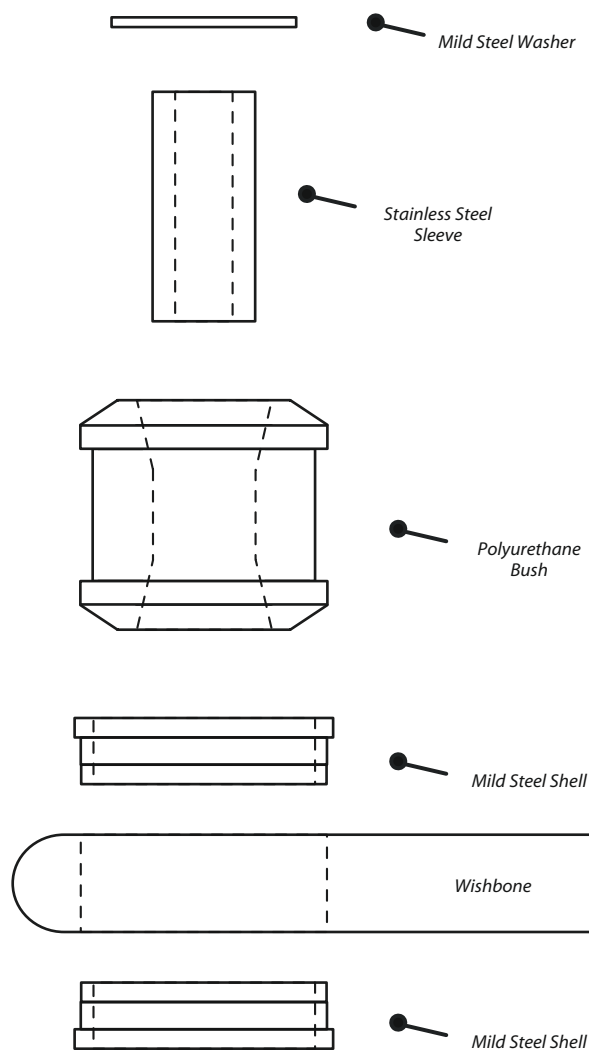

Figure 1