

# POWERFLEX®

## PART NUMBER

# PFF80-830

## DESCRIPTION

# FRONT SUBFRAME BUSH

## INSTALLATION GUIDE

### Contents (parts per pack):

12 x Polyurethane Bushes    1 x PTFE/Silicone Grease  
6 x Stainless Steel Sleeves    6 x Zinc Plated Mild Steel Washers

Please read the complete fitting instructions and check package components before fitment. These fitting instructions are to be used as a guide and in conjunction with workshop manual.

It is recommended that:

- all work to be carried out by a licensed technician;
- all safety precautions adhered to;
- wheel alignment to be checked and adjusted as required after any suspension work.
- All fasteners must be tightened to manufacturer's torque settings.

### Fitting Instructions:

1. Remove the original bush and clean off any dirt and corrosion, remembering to file away any sharp edges.
2. Insert the two polyurethane bush halves into either side of the subframe, ensuring a flush fit.
3. Apply some of the supplied grease to the bore of the bush and outside of the stainless steel sleeve, and push the sleeve in until flush with the top of the bush. The gap left at the bottom is to allow space for the smaller OE washer to sit into.
4. Place the zinc plated washer onto the top of the bush, to sit between the bush face and chassis.
4. Lift the subframe into position and align the bolt through the stainless steel sleeve and top zinc plated washer prior to tightening.
5. Tighten bolts to the manufacturer's torque settings and carry out a full geometry alignment check.

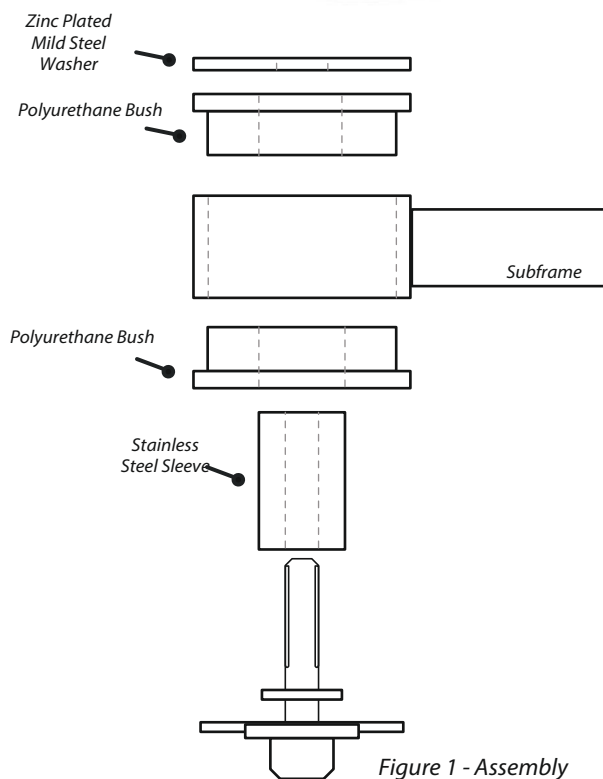

Figure 1 - Assembly

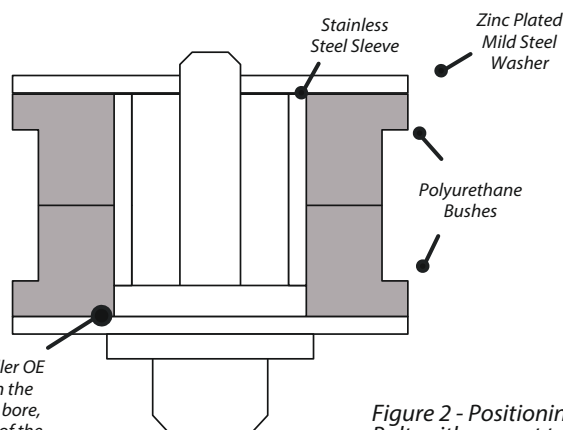

Figure 2 - Positioning of the Bolt, with respect to the other components