

# POWERFLEX®

PART NUMBER

**PFF76-702**

DESCRIPTION

**FRONT WISHBONE REAR BUSH**

## INSTALLATION GUIDE

### Contents (parts per pack):

2 x Polyurethane Bushes      1 x Grease  
2 x Stainless Steel Sleeves      2 x Zinc Plated Outer Shells

Please read the complete fitting instructions and check package components before fitment. These fitting instructions are to be used as a guide and in conjunction with workshop manual.

It is recommended that:

- all work to be carried out by a licensed technician;
- all safety precautions adhered to;
- wheel alignment to be checked and adjusted as required after any suspension work.
- All fasteners must be tensioned to manufacturer's torque settings.

### Fitting Instructions:

1. Remove the original bushes from the arm.
2. Clean any dirt or corrosion off the bore of the arm.
3. Press the zinc plated outer shell into the arm, so that it sits flush inside the arm (Figure 1).
4. Press the polyurethane bush into the outer shell, with the small lip first and at an angle, so that it sits snug inside (Figure 1).
5. Apply some of the supplied grease/washing up liquid into the bore of the polyurethane bush.
6. Push the stainless steel sleeve into the bore of the polyurethane bush so that it sits flush inside the bush (Figure 1).
7. Refit the arm back into the subframe and tension all hardware to manufacturers recommended torque settings.

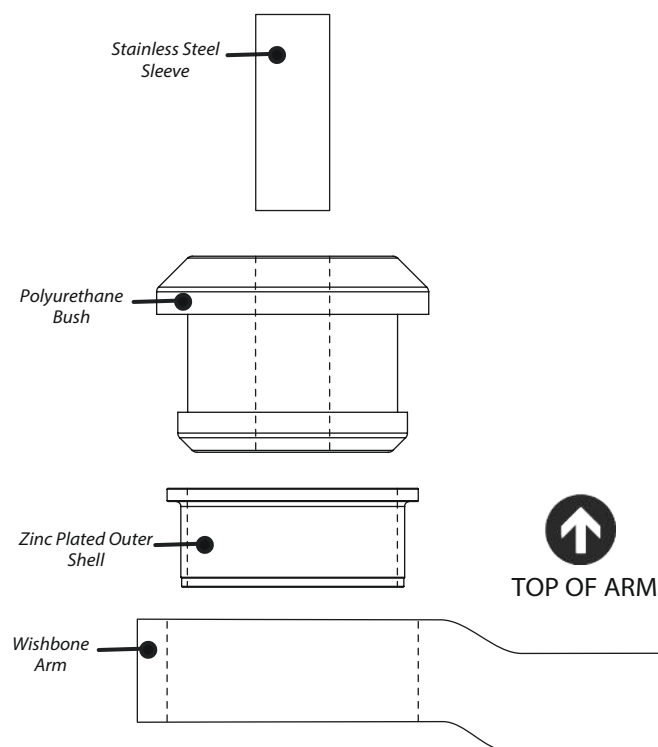

Figure 1 - diagram showing how the parts will fit together inside the arm