

POWERFLEX®

PART NUMBER

PFF57-101

DESCRIPTION

FRONT WISHBONE FRONT BUSH

INSTALLATION GUIDE

Contents (parts per pack):

4 x Polyurethane Bushes 1 x PTFE/Silicone Grease
4 x Zinc Plated Mild Steel Washers 2 x Stainless Steel Sleeves

Please read the complete fitting instructions and check package components before fitment. These fitting instructions are to be used as a guide and in conjunction with workshop manual.

It is recommended that:

- all work to be carried out by a licensed technician;
- all safety precautions adhered to;
- wheel alignment to be checked and adjusted as required after any suspension work.
- All fasteners must be tensioned to manufacturer's torque settings.

Fitting Instructions:

1. Remove the wishbone from the vehicle.
2. Remove the original rubber bush from the front of the wishbone along with its metal outer shell. The rubber part of the bush will most likely come out quite easily, leaving the shell in the arm. This will then need to be cut out.

NB. Our bush will not fit correctly if this shell is not removed.

3. Clean any dirt and corrosion from the wishbone, and file away any sharp edges using a rounded file.
4. Push the two new polyurethane bushes into the empty hole of the wishbone until flush.
5. Apply some of the supplied PTFE/Silicone grease to the bore of the bushes prior to pressing in the sleeves. The remaining grease can be applied to the end faces of the bushes.
6. Add the washers to the end of each bush and position this to the vehicle.
7. Refit the arm to the vehicle's subframe and tension all hardware to the manufacturer's recommended torque settings.

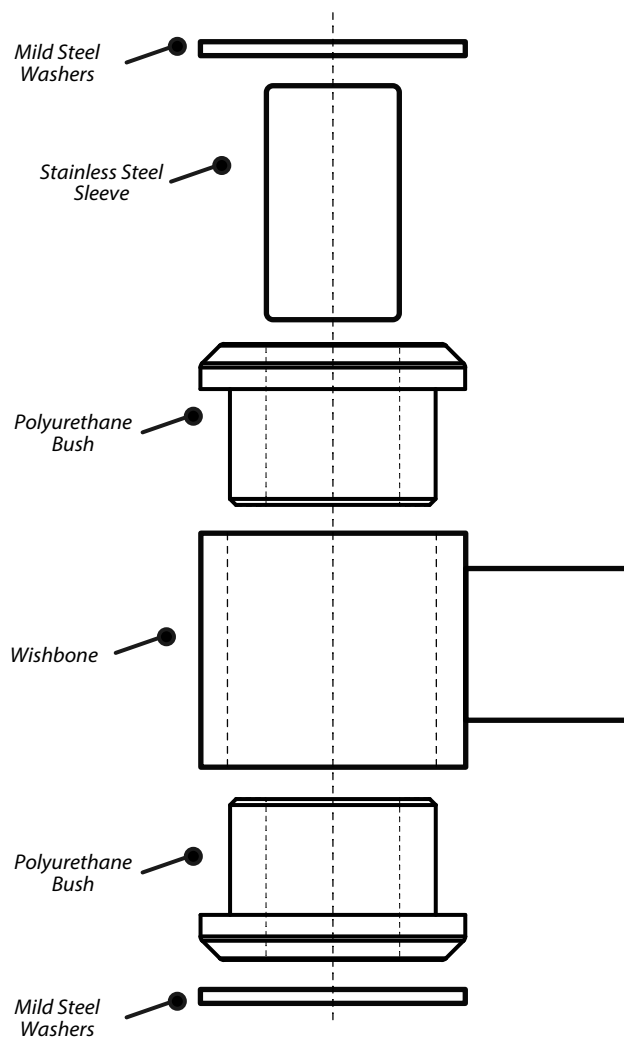

Figure 1