

# POWERFLEX®

## PART NUMBER

# PFF5-8001

## DESCRIPTION

### FRONT WISHBONE FRONT BUSH

## INSTALLATION GUIDE

### Contents (parts per pack):

2 x Polyurethane Bushes      1 x PTFE/Silicone Grease  
4 x Stainless Steel Washers    2 x Stainless Steel Sleeves

Please read the complete fitting instructions and check package components before fitment. These fitting instructions are to be used as a guide and in conjunction with workshop manual.

It is recommended that:

- all work to be carried out by a licensed technician;
- all safety precautions adhered to;
- wheel alignment to be checked and adjusted as required after any suspension work.
- All fasteners must be tensioned to manufacturer's torque settings.



### Fitting Instructions:

1. Remove the original bush from the arm, remembering to clean away any dirt and corrosion.
2. File away any sharp edges using a rounded file.
3. Using a fly press, press the Polyurethane Bush into the vacant hole, until the lips sit on the outer surfaces of the arm. *Tip: lubricate the vacant hole with washing up liquid and press the bush in at an angle to ease insertion.*
4. Apply some of the supplied grease to the bore of the bushes, and insert the Stainless Steel Sleeve into the bore until it sits flush.
5. Place the Stainless Steel Washers on each end face of the bush with the chamfered side facing outwards.
6. Refit the arm to the subframe, remembering to tension all hardware to manufacturers recommended torque settings.

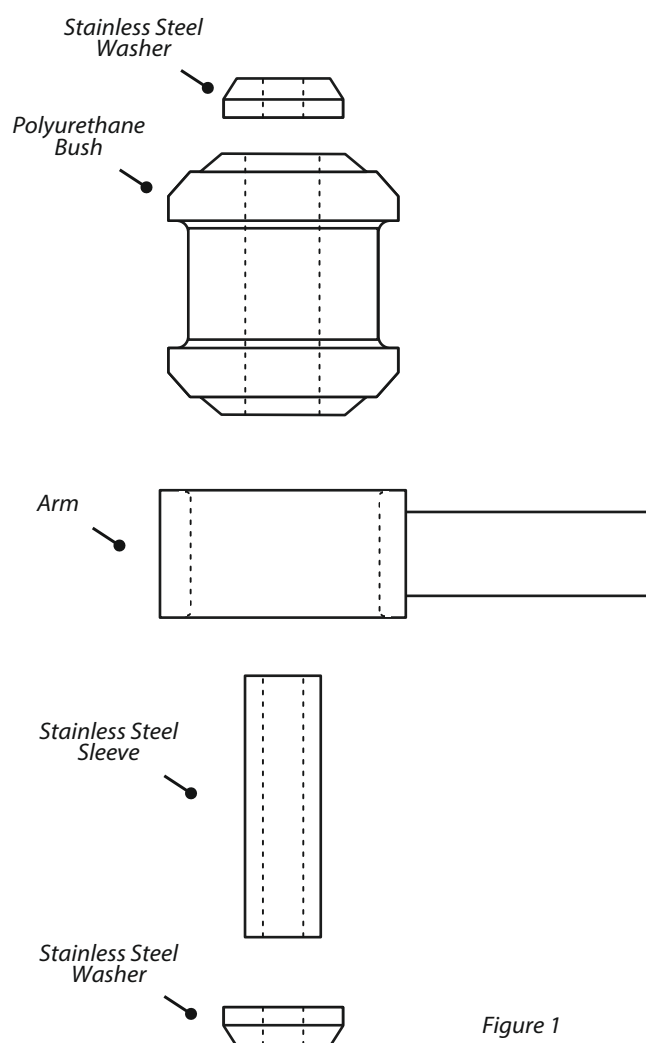

Figure 1