

POWERFLEX®

PART NUMBER

PFF5-6001G

DESCRIPTION

FRONT RADIUS ARM TO CHASSIS BUSH

INSTALLATION GUIDE

Contents (parts per pack):

- 4 x Polyurethane Bushes
- 1 x PTFE/Silicone Grease
- 2 x Zinc Plated Mild Steel Washers
- 2 x Stainless Steel Sleeves

Please read the complete fitting instructions and check package components before fitment. These fitting instructions are to be used as a guide and in conjunction with workshop manual.

It is recommended that:

- all work to be carried out by a licensed technician;
- all safety precautions adhered to;
- wheel alignment to be checked and adjusted as required after any suspension work.
- All fasteners must be tensioned to manufacturer's torque settings.

Fitting Instructions:

1. Remove original bush from arm.
2. Clean any dirt and corrosion from bore in arm, removing any sharp edges around bore using a file.
3. Fit the polyurethane bushes into arm.
4. Apply supplied grease in and around bore of polyurethane bushes.
5. Insert stainless steel sleeve into bush as shown in Figure 2, with the bore centered away from the centre of the vehicle.
6. Place each zinc plated mild steel washer on either side of the bush.
6. Refit arm to the car. Tension all hardware to manufacturers recommended torque settings.



Zinc Plated Mild Steel Washer →



Stainless steel Sleeve →



Polyurethane Bush →

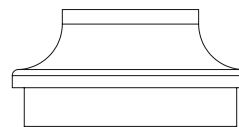

Radius Arm →

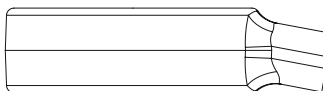

Polyurethane Bush →

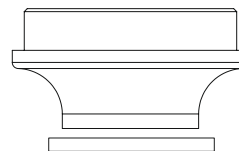

Zinc Plated Mild Steel Washer →

Figure 1

