

POWERFLEX®

PART NUMBER

PFF5-5301

DESCRIPTION

FRONT WISHBONE REAR BUSH

INSTALLATION GUIDE

Contents (parts per pack):

- 2 x Polyurethane Bushes
- 1 x PTFE/Silicone Grease
- 2 x Steel Shells
- 2 x Zinc Plated Mild Steel Washers

Please read the complete fitting instructions and check package components before fitment. These fitting instructions are to be used as a guide and in conjunction with workshop manual.

It is recommended that:

- all work to be carried out by a licensed technician;
- all safety precautions adhered to;
- wheel alignment to be checked and adjusted as required after any suspension work.
- All fasteners must be tensioned to manufacturer's torque settings.



Fitting Instructions:

1. Remove the original bush from the arm.
2. Clean any dirt and corrosion from the bracket and file off any sharp edges.
3. Press the steel shell into the bracket, ensuring that the notch on the outer shell lines up with the notch on the metal bracket. If necessary apply soap based lubricant to ease the pressing of the shell.
4. Push the polyurethane bush all the way into the shell. This will leave room for the metal steel washer on top of the bush.
5. Fit the washer onto the pin of the arm and push the metal bracket containing the bush and shell onto the pin. Ensure that the top of the polyurethane bush is facing the washer as shown in Figure 1. The washer should touch the polyurethane bush.
6. Refit the arm to the vehicle and tension all hardware to manufacturers recommended torque settings.

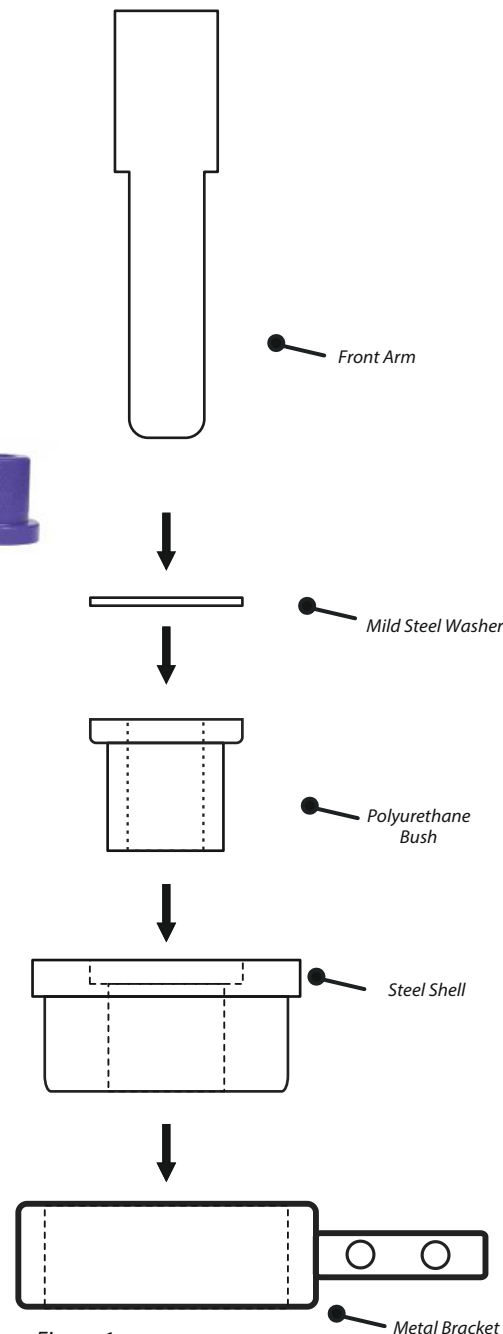

Figure 1