

POWERFLEX®

PART NUMBER

PFF5-1320

DESCRIPTION

LOWER ENGINE MOUNT LARGE BUSH

INSTALLATION GUIDE

Contents (parts per pack):

- 2 x Polyurethane A Bushes
- 1 x PTFE/Silicone Grease
- 2 x Polyurethane B Bushes
- 1 x Stainless Steel Sleeves

Please read the complete fitting instructions and check package components before fitment. These fitting instructions are to be used as a guide and in conjunction with workshop manual.

It is recommended that:

- all work to be carried out by a licensed technician;
- all safety precautions adhered to;
- wheel alignment to be checked and adjusted as required after any suspension work.
- All fasteners must be tensioned to manufacturer's torque settings.



Fitting Instructions for Mini F56:

1. Remove original bush from the arm, clean any dirt and corrosion from bore in arm.
2. Push the A components of the bush into the bore of the arm, positioning the bore of the bush nearest the inside arm to maintain its original offset position.
3. Apply some of the supplied grease to the bore of the bush and insert the sleeve.
4. Refit the arm to the car using the original bolt and washer; tension all hardware to manufacturers recommended torque settings.
5. To limit the flexibility of the bush, add the supplied polyurethane inserts (B) into each part of the bush.

Fitted Bush



Offset so that the bore is closer to the centre of the mount

Fitted Bush + Insert

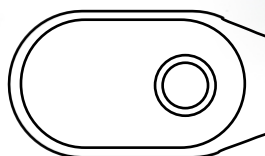

Fitting Instructions for BMW i3:

1. Remove original bush from the arm, clean any dirt and corrosion from bore in arm.
2. Push the A components of the bush into the bore of the arm, positioning the bore of the bush nearest the outside edge to maintain its original offset position.
3. Apply some of the supplied grease to the bore of the bush and insert the sleeve.
4. Refit the arm to the car using the original bolt and washer; tension all hardware to manufacturers recommended torque settings.
5. To limit the flexibility of the bush, add the supplied polyurethane inserts (B) into each part of the bush.



Offset so that the bore is closer to the edge of the mount



Fitted bush + Insert

