

# POWERFLEX®

PART NUMBER

## PFF5-131G

DESCRIPTION

## ROLL CENTRE ADJUSTER

### INSTALLATION GUIDE

#### Contents (parts per pack):

- 2 x Anodised Aluminium Spacer Block
- 2 x Anodised Aluminium Washers
- 4 x M10 High Tensile Flanged Head Bolts

Please read the complete fitting instructions and check package components before fitment. These fitting instructions are to be used as a guide and in conjunction with workshop manual.

It is recommended that:

- all work to be carried out by a licensed technician;
- all safety precautions adhered to;
- wheel alignment to be checked and adjusted as required after any suspension work.
- All fasteners must be tensioned to manufacturer's torque settings.

#### Fitting Instructions:

1. Remove the original bolts and the ball joint from the mount. Retain the ball joint for reassembly.

2. Place the aluminium spacer block in the mount, with the cylindrical shape inside the bore of the mount and the spacer sat on top of the mount. The holes in the spacer should line up with the bolt holes in the mount.

3. If required, place the washer on the exposed surface of the spacer.

**The use of the washer is only suitable for cars with 17-inch wheels and above.**

4. While holding the unit in place, position the original ball joint on top of the washer or the spacer (if not using the washer). A minimum of 3mm clearance is required between ball joint and inner diameter of the wheel.

5. Ensure that the bolting holes on all the components are aligned.

6. Assemble the unit with the M10 bolts, and tension all hardware to manufacturers recommended torque settings.



Figure 1- The roll centre adjuster unit without washer



Figure 2- The roll centre adjuster unit with washer

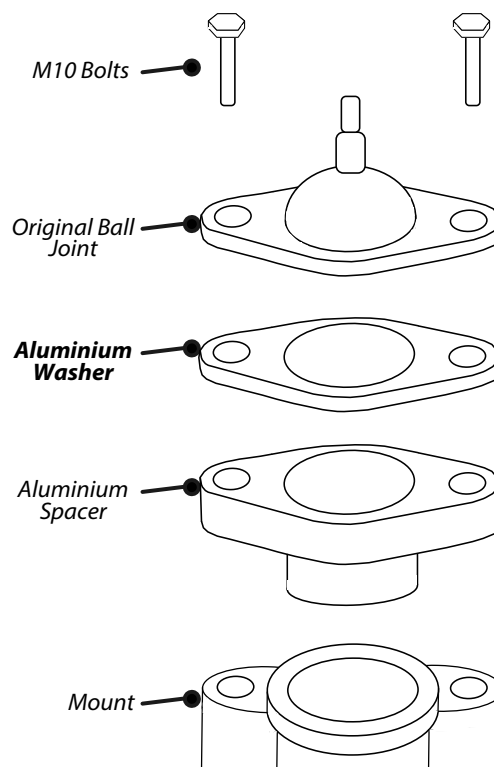

Figure 3