

# POWERFLEX®

## PART NUMBER

# PFF3-905

## DESCRIPTION

## LOWER ENGINE MOUNT SMALL BUSH

## INSTALLATION GUIDE

### Contents (parts per pack):

- 1 x PFF3-905 Polyurethane Bush
- 1 x Stainless Steel Sleeve
- 1 x Zinc Plated Mild Steel Washers
- 1 x PTFE/Silicone Grease

Please read the complete fitting instructions and check package components before fitment. These fitting instructions are to be used as a guide and in conjunction with workshop manual.

It is recommended that:

- all work to be carried out by a licensed technician;
- all safety precautions adhered to;
- wheel alignment to be checked and adjusted as required after any suspension work.
- All fasteners must be tensioned to manufacturer's torque settings.

### Fitting Instructions:

1. Remove the mount from the car.
2. Using a countersink drill or a 16mm , drill the original bracket and sleeve allowing the bracket to come away from the sleeve in the bush and be removed from the bracket. Make a note of which side the bracket fits onto the mount, as the bracket will be reused. **Ensure the drilled bore is 16mm before attempting to fit the new bush.**
3. Remove the original bush from the mount.
4. Fit the PFF3-905 bush into the mount, a little washing up liquid helps the fitting. Ensure the lip with the larger chamfer is pressed into the vacant hole in the mount first (where the original bush sat) and sits flush within the hole.
5. Apply some of the supplied grease into the bore of the bush then fit the stainless steel sleeve, making sure the end with the small spigot faces towards the bracket side.
6. Fit the mount back onto the car. Place the washer between the bush and gearbox to create a smooth face. Make sure to refit the bracket you drilled off earlier over to the spigot of the sleeve. When refitting the mount, make sure to tension all hardware to manufacturers recommended torque settings.



### TOP OF CAR

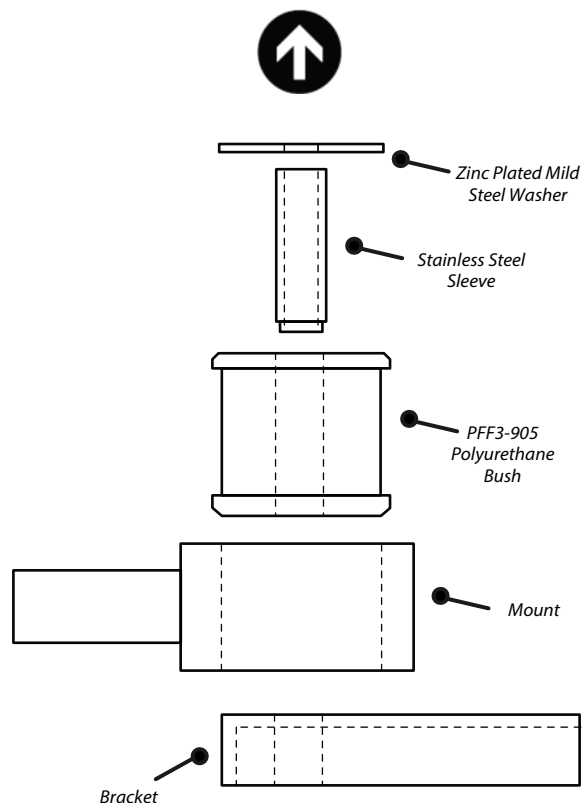

Figure 1