

# POWERFLEX®

## PART NUMBER

# PFF2-104

## DESCRIPTION

## FRONT UPPER WISHBONE BUSH

## INSTALLATION GUIDE

### Contents (parts per pack):

8 x Polyurethane Bushes 2 x PTFE/Silicone Grease

8 x Nylon Washers 4 x Stainless Steel Sleeves

Please read the complete fitting instructions and check package components before fitment. These fitting instructions are to be used as a guide and in conjunction with workshop manual.

It is recommended that:

- all work to be carried out by a licensed technician;
- all safety precautions adhered to;
- wheel alignment to be checked and adjusted as required after any suspension work.
- All fasteners must be tensioned to manufacturer's torque settings.

### Fitting Instructions:

1. Remove front upper wishbone from vehicle.
2. Carefully remove OEM bushes from the wishbone. Delicate use of a workshop press is recommended, and ensure the arm is well supported around it's circumference.
3. Clean bore of wishbone and remove any burrs or sharp edges.
4. Push the Polyurethane bushes into place in the wishbone bores (Figure 1).
5. Apply the supplied grease liberally into the knurled bore and outside faces of the bushes and the outside of the sleeves.
6. Push the sleeves into the bushes (Figure 1).
7. Using a small amount of grease, attach the nylon washers around the metal sleeves at each end of each bush (Figure 1).
8. Refit the arm to the car, ensuring to tighten all hardware to manufacturers recommended torque settings.

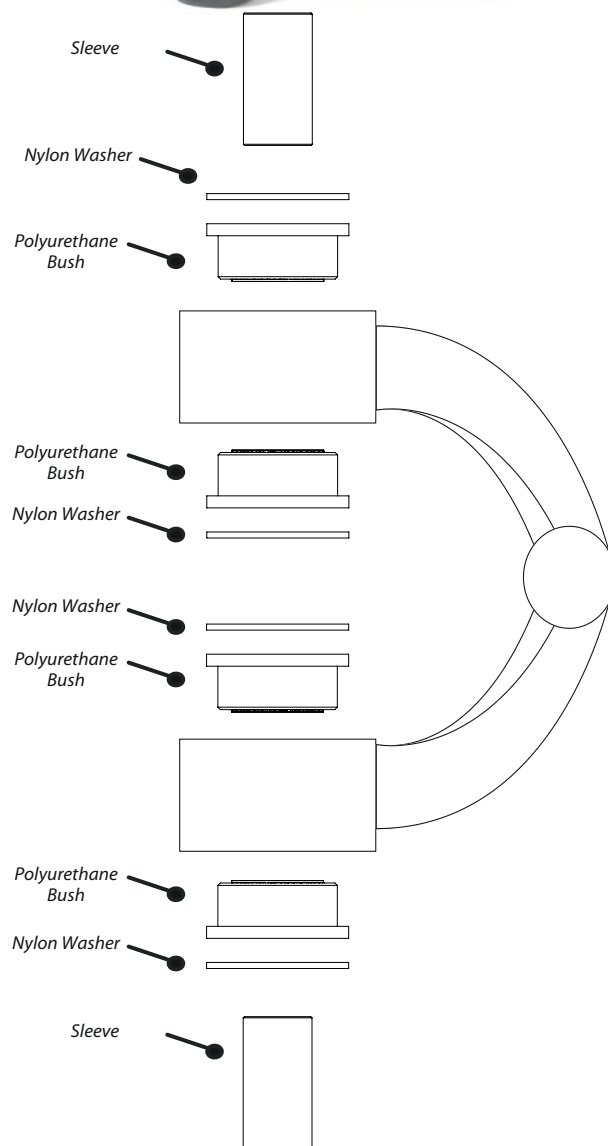

Figure 1