

# POWERFLEX®

## PART NUMBER

# PFF12-702

## DESCRIPTION

## FRONT WISHBONE REAR BUSH

## INSTALLATION GUIDE

### Contents (parts per pack):

2 x Polyurethane A Bushes    1 x PTFE/Silicone Grease  
4 x Polyurethane B Bushes    4 x Stainless Steel Sleeves  
2 x Zinc Plated Mild Steel Shells

Please read the complete fitting instructions and check package components before fitment. These fitting instructions are to be used as a guide and in conjunction with workshop manual.

It is recommended that:

- all work to be carried out by a licensed technician;
- all safety precautions adhered to;
- wheel alignment to be checked and adjusted as required after any suspension work.
- All fasteners must be tensioned to manufacturer's torque settings.



### Fitting Instructions:

1. Remove the original rubber bush from the front wishbone rear position.

2. Clean any dirt and corrosion from the bore of the arm and file off any sharp edges.

3. Press in the zinc plated mild steel outer shell with the smaller diameter lip being pushed in from the top of the arm.

4. Push polyurethane part A into the bore of the metal outer shell so that it sits flush inside.

**Tip: apply some washing up liquid to polyurethane part A and push it in at an angle for ease of fitting.**

5. Place polyurethane part B on both end faces of polyurethane part A.

6. Apply some of the supplied grease into the bore of the polyurethane bushes and push in the both stainless steel sleeves so that the larger diameter on the sleeve sits against the bush, as shown in Figure 2.

7. Refit the front wishbone arm back to the vehicle and tension all hardware to manufacturers recommended torque settings.

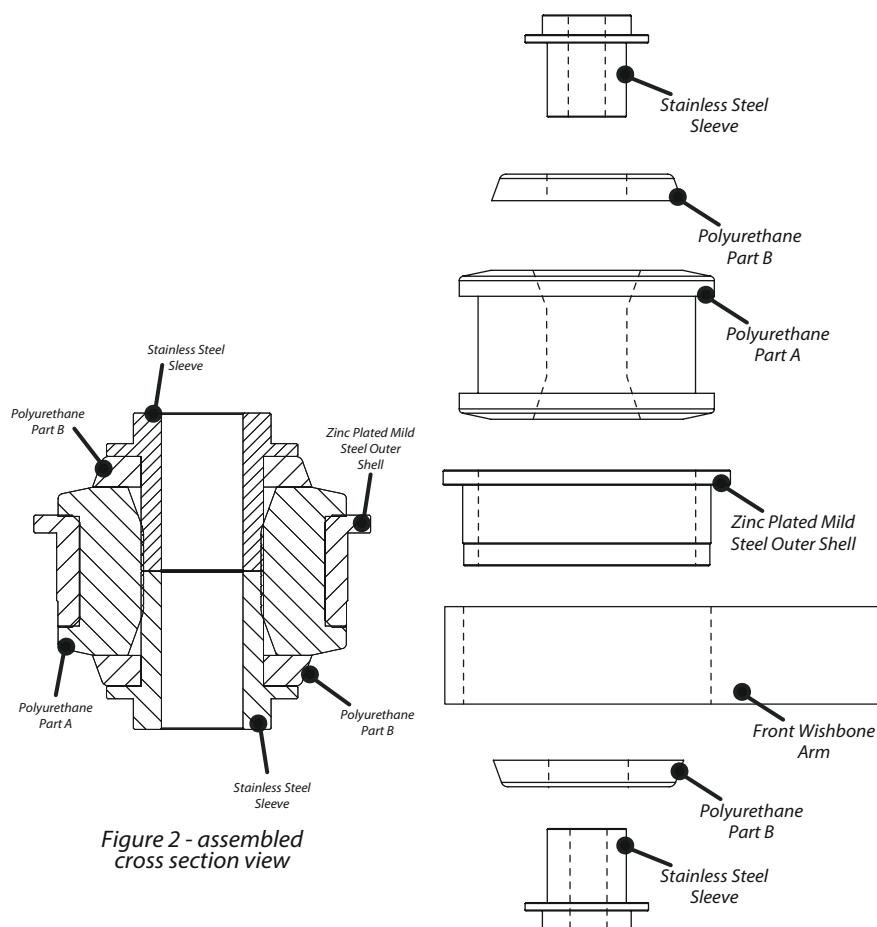

Figure 2 - assembled cross section view

Figure 1